

FOR FINAL APPROVAL

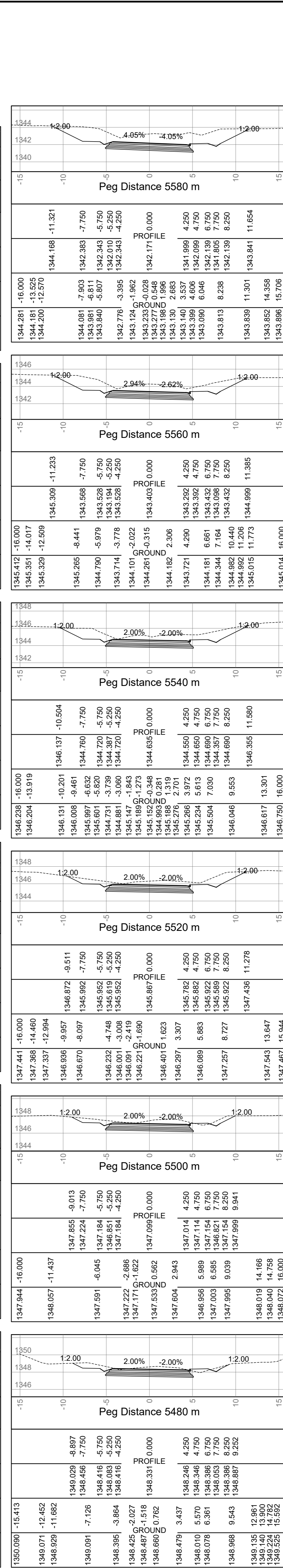
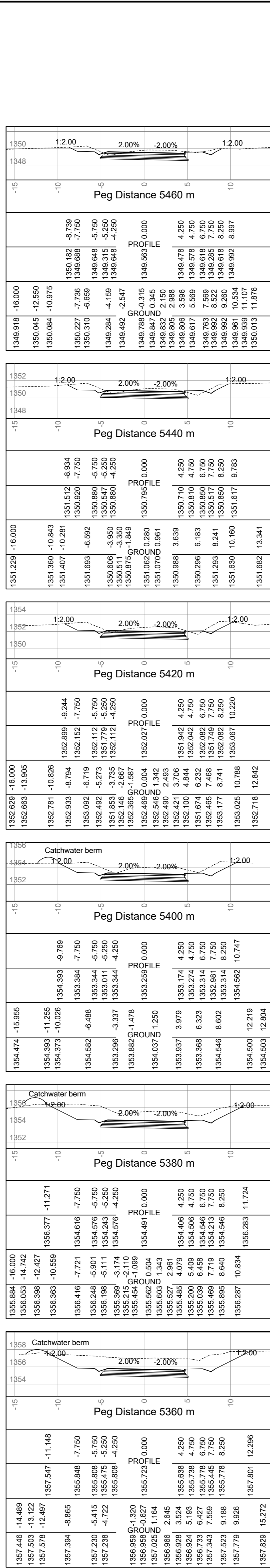
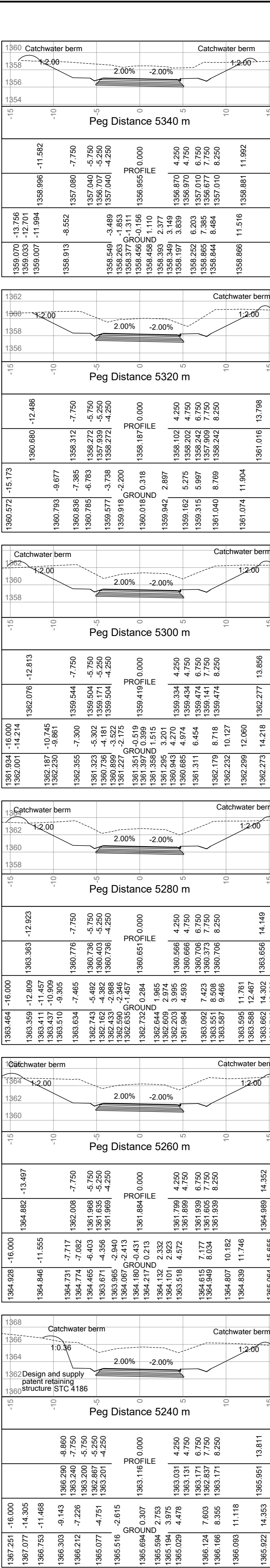
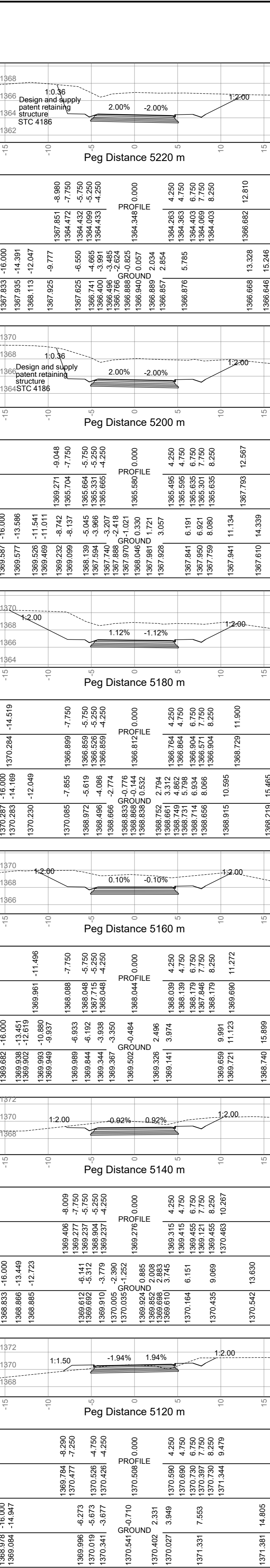
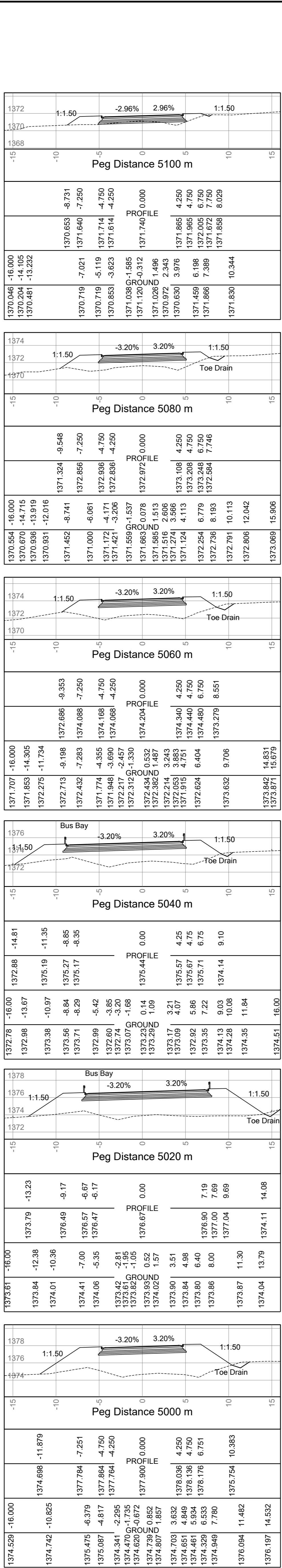
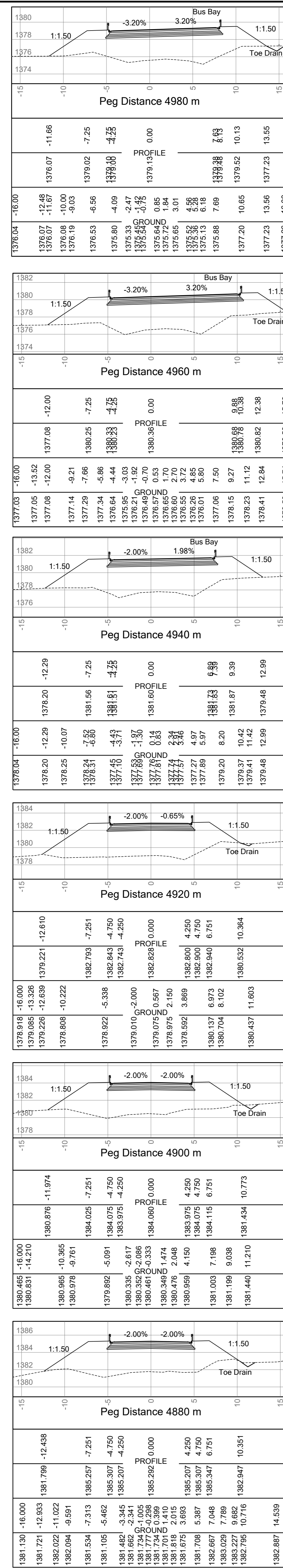

SYMBOL	DATE	DESCRIPTION	CHECKED	SIGNED
D	OCT 2019	FOR FINAL APPROVAL	KG	
C	AUG 2018	FOR APPROVAL	KG	
B	AUG 2016	FOR APPROVAL	MM	

AS BUILT	
SUPERVISING ENGINEER	DATE
SUPERVISING AUTHORITY	

CONTINUED FROM:	C41978	DESIGNED BY:	M. SINGH
CONTINUED ON:	C41980	CHECKED BY:	K. GOVENDER
LONG SECTION NO.:	C41987	DRAWN BY:	M MARAIS
DESIGN PLAN NO.:	C41969	CHECKED BY:	S RAMATHER
NAIDU CONSULTING - CONSULTING ENGINEER		K GOVENDER	
SIGN:		DATE:	

Designed by-

NAidu Consulting no.- D267 /2519 /D

Department:
Transport
Province of KwaZulu-Natal

TRANSPORTATION ENGINEERING - CHIEF ENGINEER
HEAD: TRANSPORT

UPGRADE OF MAIN ROAD P402 (HOLY FAMILY CONVENT - KWAMGWAGWA)
PORTION
FROM KM 0+000 TO KM 7+517
CROSS SECTION

STAKED KM DISTANCE	KM 4,480 to KM 5,380	SHEET	8 OF 11
SCALE	HOR 1 : 250 VERT 1 : 250	PLAN No.	C41979

C41979